

HYDRA-GUARD / HYDRA-GUARD WB / J-COTE / J-COTE WB WATERPROOFING MEMBRANE
CRACK TREATMENT GREATER THAN 1/16" CONSTRUCTION JOINTS OR MOVING CRACKS

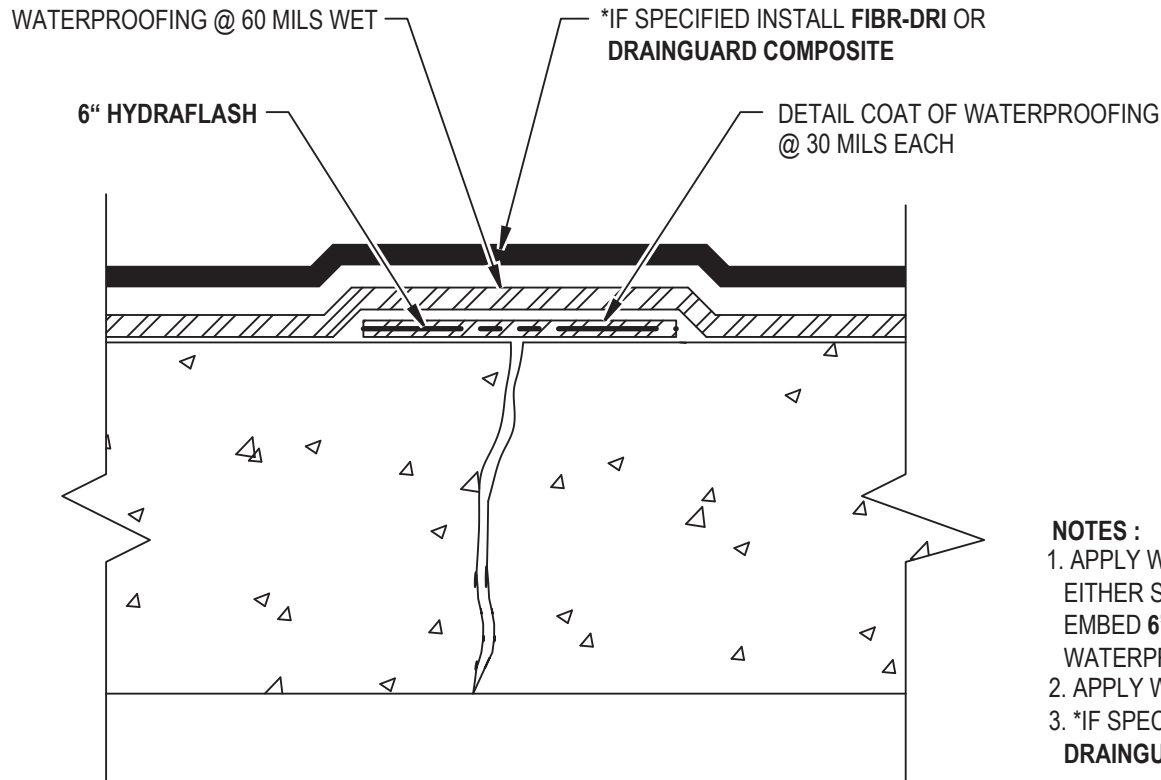

- NOTES :**
1. APPLY WATERPROOFING 3" ON EITHER SIDE OF CRACK @ 30 MILS AND EMBED 6" HYDRAFLASH INTO THE WATERPROOFING.
 2. APPLY WATERPROOFING @ 60 MILS WET.
 3. *IF SPECIFIED INSTALL FIBR-DRI OR DRAINGUARD COMPOSITE.

applied
technologies llc

P.O. Box 18476 | Fairfield, OH 45018
(513) 939-3767 | Toll Free (877) 277-5948 | Fax (513) 939-3787
www.appliedtechnologies.com

SWP-2