

**HYDRA-GUARD / HYDRA-GUARD WB / J-COTE / J-COTE WB WATERPROOFING MEMBRANE**  
CRACK TREATMENT NON-MOVING CRACKS LESS THAN 1/16"

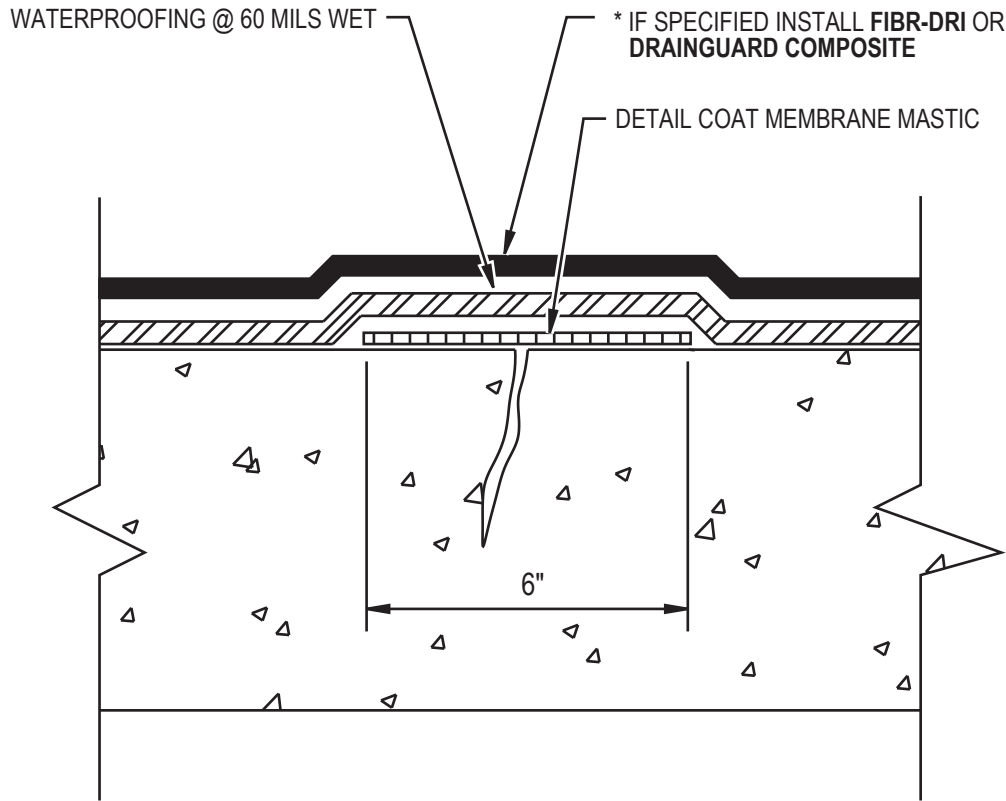

- NOTES**
1. APPLY MEMBRANE MASTIC 2" ON EITHER SIDE OF CRACK
  2. APPLY WATERPROOFING @ 60 MILS WET
  3. \* IF SPECIFIED INSTALL **FIBR-DRI** OR **DRAINGUARD COMPOSITE**



P.O. Box 18476 | Fairfield, OH 45018  
(513) 939-3767 | Toll Free (877) 277-5948 | Fax (513) 939-3787  
www.appliedtechnologies.com

**SWP-1**